



960 Commercial Street

Palo Alto, California

PROPERTY OVERVIEW

Stand Alone Commercial /
R&D Building

HIGHLIGHTS

- $\pm 5,000$ SF Building
- $\pm 10,000$ SF Lot
- Fully Remodeled in 2003
- 2 ADA Restrooms
- Kitchen
- 1 Large Office / Conference Room
- Dedicated Server Room
- 2 Rollups
- Secured and Gated Parking / Yard
- Fully HVAC'd Warehouse and Office

LEASE TERMS

- \$2.65 PSF NNN w/ \$.80 nets

FOR LEASE → STAND ALONE COMMERCIAL / R&D BUILDING

960 Commercial Street, Palo Alto



CONTACT US

Anthony Kamm

ak@seq-rs.com

650.888.3858

CAL DRE LIC NO. 01783456

Ryan Pegnim

rcp@seq-rs.com

650.346.9820

CAL DRE LIC NO. 01478696



FOR LEASE → STAND ALONE COMMERCIAL / R&D BUILDING

960 Commercial Street, Palo Alto

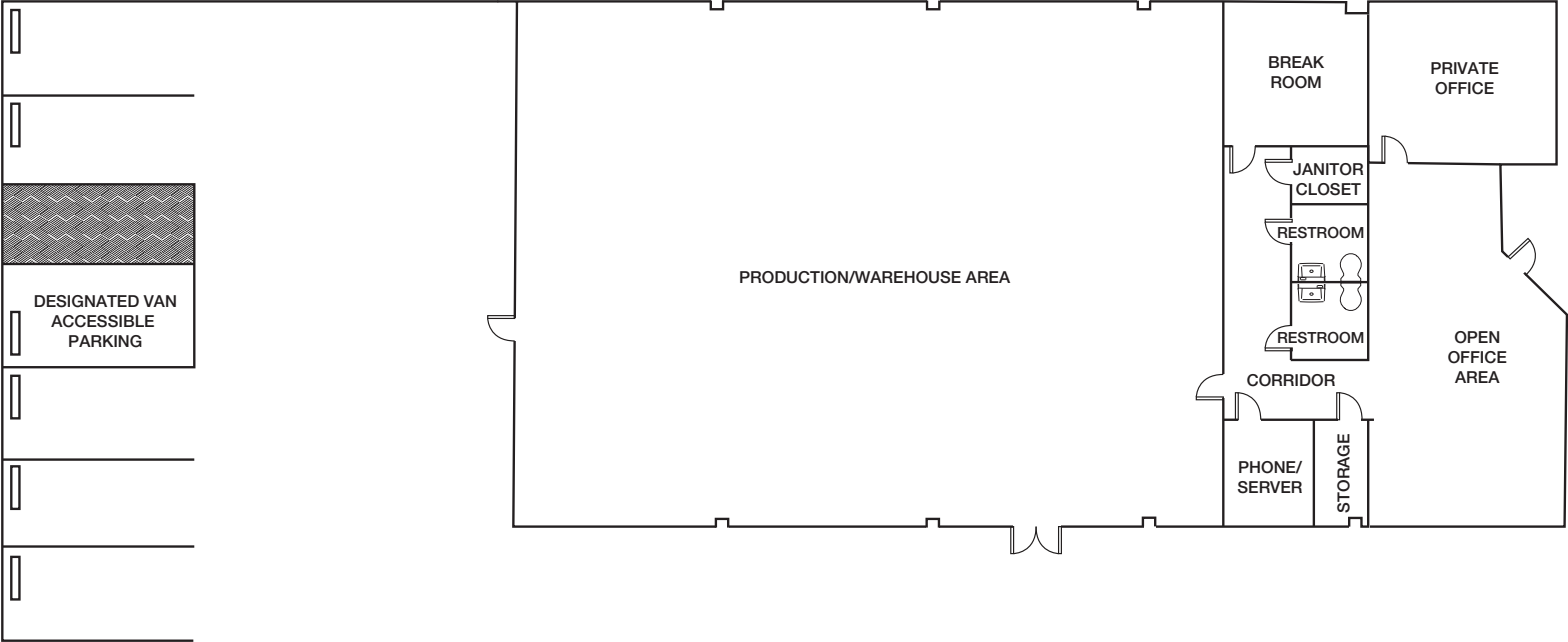

CONTACT US

Anthony Kamm
ak@seq-rs.com
650.888.3858
CAL DRE LIC NO. 01783456

Ryan Pegnim
rcp@seq-rs.com
650.346.9820
CAL DRE LIC NO. 01478696



FOR LEASE → STAND ALONE COMMERCIAL / R&D BUILDING

960 Commercial Street, Palo Alto

LOCATION OVERVIEW

960 Commercial Street is conveniently located on the San Francisco Peninsula off of Highway 101. The Facility is 25 minutes south of San Francisco International Airport and Roughly 15 minutes north of San Jose International Airport. The property is located off the San Antonio Road exit of Highway 101. The facility provides easy access to Hwy 101, 280, El Camino Real and CalTrain.



CONTACT US

Anthony Kamm

ak@seq-rs.com

650.888.3858

CAL DRE LIC NO. 01783456

Ryan Pegnim

rcp@seq-rs.com

650.346.9820

CAL DRE LIC NO. 01478696



LOCATION & LOCAL AMENITIES